

6901SCHA Switch

Images:

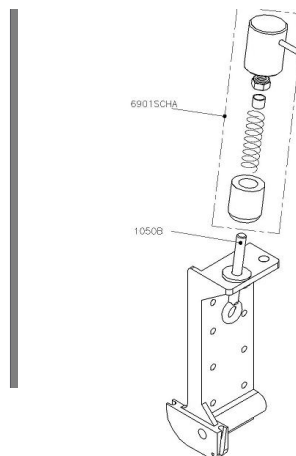
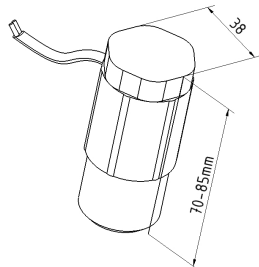

Description:

- | | |
|-------------------------|--|
| - Subcategory | : 03. Others |
| - IND/RES | : IND |
| - Full package quantity | : 25 |
| - Unit | : piece (1) |
| - Weight / Unit | : 0,09kg |
| - Colour | : Black |
| - Length | : 70-85mm |
| - Width | : 38mm |
| - Product Family | : 28 Bottom brackets |
| - Technical description | : The switch is used on a bottom bracket with cable adjustment on a power operated door. When the cable tension drops, because of a sudden decrease of the door weight on the cable, the switch operates a signal which stops the motor. |