

## Herkules2E Motion detector

Images:

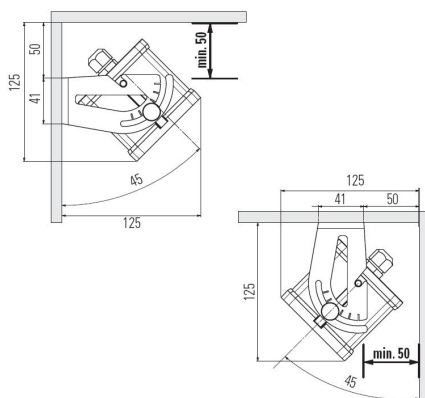

### Description:

- |                          |  |
|--------------------------|--|
| - Subcategory            | : Sensors and safety   |
| - IND/RES                | : IND  |
| - Full package quantity  | : 1  |
| - Unit                   | : piece (1)  |
| - Weight / Unit          | : 0,72kg   |
| - Material               | : Aluminium, polycarbonate   |
| - Height                 | : 75mm   |
| - Length                 | : 134mm  |
| - Width                  | : 82mm   |
| - Product Family         | : a 064  |
| - Marking                | : Bircher Reglomat   |
| - Commercial description | : Programming with switches or REGLOBEAM controller, incl. 7m cable  |
| - Technical description  | : Herkules2E is specifically developed for use with industrial doors. It detects, differentiates between or masks out people or vehicles and can switch the output relays (motor stop) separately, depending on the requirement. Differentiation between or masking of people and vehicles. With a second relay you can set the one relay to Pulse on exit, this will give a signal when the person is leaving or is standing still. Saves time and energy! (door must be secured with safety edge or light curtain) Part of Value Pack Speed. |