

421AC Bottom bracket

Images:

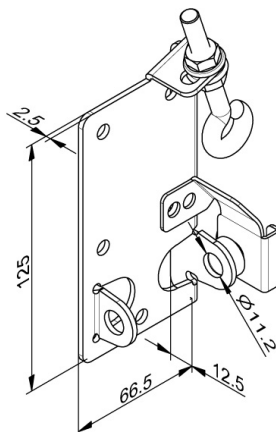
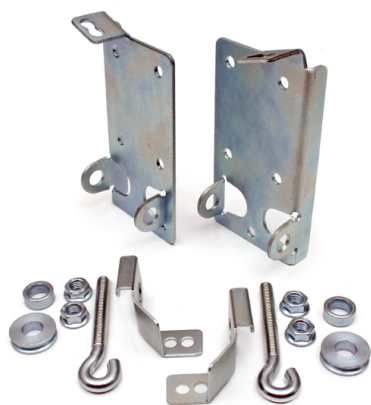

Description:

- | | |
|--------------------------|---|
| - Subcategory | : 01. Adjustable |
| - IND/RES | : RES |
| - Full package quantity | : 20 |
| - Unit | : pair (2) |
| - Weight / Unit | : 0,63kg |
| - Material | : Galvanised Steel |
| - Width | : 60mm |
| - Thickness | : 2,5mm |
| - Product Family | : 02 Bottom brackets |
| - Adjustable | : Yes |
| - Max. cable diameter | : 4mm |
| - Max. door weight | : 160kg |
| - Marking | : 421ACL/R |
| - Commercial description | : 11mm roller shaft, |
| - Technical description | : Adjustable bottom bracket for residential doors. Up to 160kg of doorweight. |