

## 312RSC Bearing plate

Images:

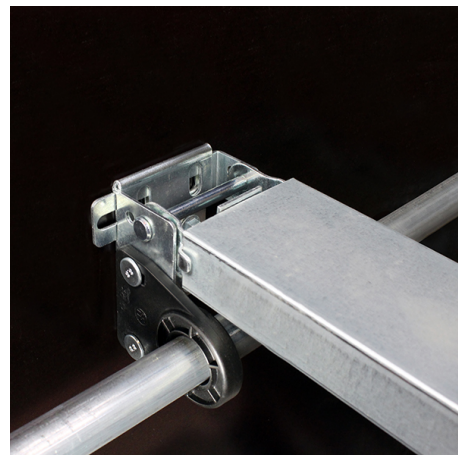
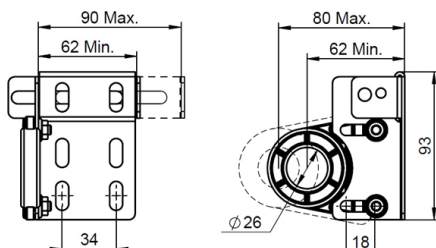
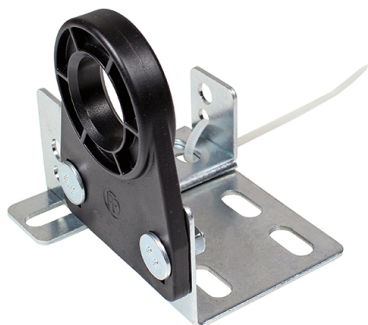

Description:

- Subcategory	: 03. Residential
- IND/RES	: RES
- Full package quantity	: 50
- Unit	: piece (1)
- Weight / Unit	: 0,23kg
- Material	: POM
- Height	: 93mm
- Width	: 83mm
- Thickness	: 2mm
- Product Family	: a 001
- Galvanised	: Yes
- Heart-to-heart	: 61,5mm-79,5mm
- Inside diameter	: 26mm
- Technical description	: Wall bracket with adjustable 1" intermediate bearing and an adjustable drawbar connection. Can be used for 62mm - 80mm heart-to-heart sizes, and drawbar connections between 62mm and 90mm.