

ISTT & ISTT-125:

Industrial Spring Tensioning Tool

ISTT use in combination with FlexiForce spring fittings and 1" shaft

ISTT-125 use in combination with FlexiForce spring fittings and 1¼" shaft

Max. Torque 210Nm

Max. RPM 2500



INSTALLATION, USE AND MAINTENANCE BY THE INSTALLER

© All rights reserved. FlexiForce® 2017

Before you start; read this manual carefully and check the video on youtube

It is advised to practise the use of the tool in a test environment

If anything is unclear or should you have queries, please contact FlexiForce or your supplier

ATTENTION! GENERAL WARNINGS!

To use, operate and service this tool, a number of precautions must be taken.

For safety reasons pay heed to the warnings and instructions given below !



If in doubt, contact your supplier

- ✓ This manual has been written for use by experienced fitters and as such is not suitable for d.i.y. purposes or for use by trainee fitters.
- ✓ This manual only describes the operation and servicing of the industrial spring tensioning tool.
- ✓ All safety warnings or remarks valid for the installation of the complete sectional overhead door need to be considered
- ✓ Certain components may be sharp or have jagged edges. As such you are advised to wear safety gloves.
- ✓ The guarantee will terminate in case components will be added or changed without any consultation with the supplier
- ✓ During tensioning, springs can exert large forces. Ensure that you are standing in a steady position.
- ✓ Ensure that there is sufficient light during installation. Make sure that there is no one else present other than the fitters.
- ✓ All rights derived from this manual are reserved. Technical information is subject to change without notice



CHECK THE TOOL FOR DAMAGES BEFORE TENSIONING A SPRING, DO NOT USE THE TOOL WHEN DAMAGED



UNDER NO CIRCUMSTANCES DISASSEMBLE THE TOOL, BEFORE FIXING THE WINDING PLUG TO THE SHAFT !



ALWAYS USE THE SICKLE LEVER TO SECURE THE TOOL



MAKE SURE THE GEAR COVER IS FIXED TO THE DRIVE UNIT BEFORE TENSIONING



MAKE SURE THE PROPER SIZE INSERT PIN IS USED ON THE SPRING WINDING PLUG



DO NOT EXCEED THE PRESCRIBED MAX. RPM AND MAX. TORQUE



ONLY USE ISTT ON 1" (25.4MM) SHAFT



ONLY USE ISTT-125 ON 1 1/4" (31.75MM) SHAFT



ONLY USE ON FF SPRING WINDING PLUGS



MAKE SURE THE INSERT PIN IS TIGHTENED CORRECTLY IN THE GEAR WHEEL



ALWAYS USE THE RIGHT HAND DIRECTION OF THE DRILL TO WIND UP SPRINGS



USE PROPER DRILL



DO NOT DISMANTLE OR BEND AWAY THE SAFETY LEVER FROM THE DRIVE UNIT



CARRY OUT THE MAINTENANCE AS PRESCRIBED

With the proper maintenance and correct usage the ISTT is suitable to tension at least 3000 torsion springs without any problems.

Maintenance and checks

Keep the teeth of the gear wheel clean and greased.

Keep the bore of the gear wheel clean and grease the surface of the bore before use.

Inspect the tool for wear, clearance, damage before use. Do not use the spring tensioning tool if safety is not assured !

95 122 991 rev. 30-10-2018

1

Maintenance and checks

Check dimensions A,B,C and D !
(See page 9,10 and 11)

Do not use the spring tensioning tool if wear limits are crossed !

95 122 991 rev. 30-10-2018

2



Keep sickle lever clean.

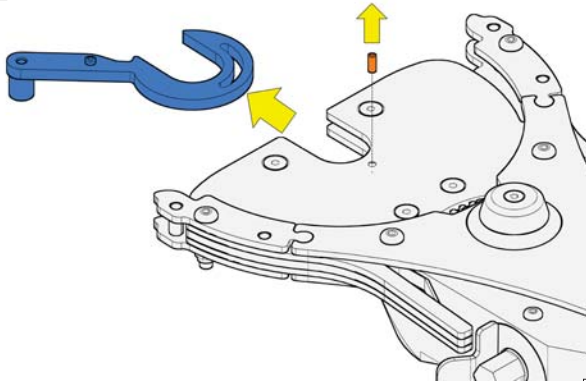

95 122 991 rev. 30-10-2018

3



Grease the nipple on the rear after tensioning 50 springs

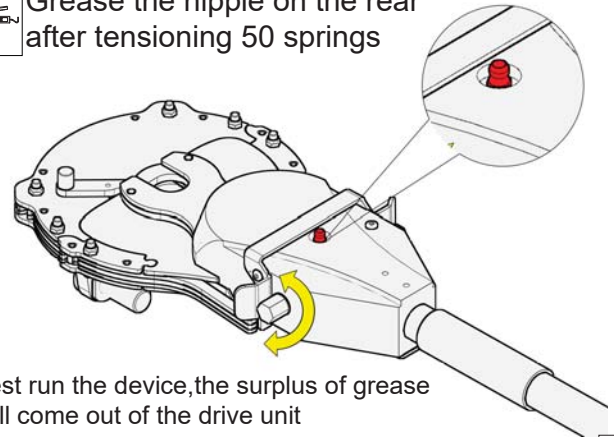

Test run the device, the surplus of grease will come out of the drive unit

95 122 991 rev. 30-10-2018

4

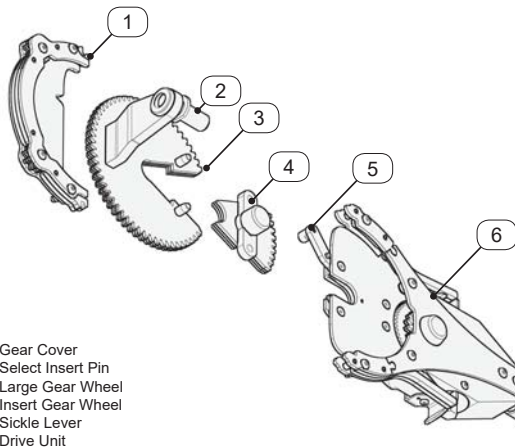

- 1 : Gear Cover
- 2 : Select Insert Pin
- 3 : Large Gear Wheel
- 4 : Insert Gear Wheel
- 5 : Sickle Lever
- 6 : Drive Unit

Needed tools

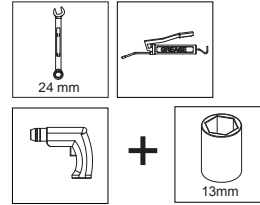

Suitable drill

Cordless drill: 18V n = 1500 RPM direction of rotation left hand and right hand.

Power drill: 230V, 750 W n = 2500 RPM **max.** direction of rotation left hand and right hand.

To wind up a spring always use the right hand direction of rotation of the drill.

Select ISTT & Insert Pin

FF Spring plug	SHAFT	TOOL	Insert Pin
FF200	1"	ISTT	Ø13,3x43
FF263	1"	ISTT	Ø16x33
FF375	1"	ISTT	
FF375N	1"	ISTT	
FF600N	1"	ISTT	
FF600N125	1¼"	ISTT-125	

- * Use with FF spring plugs only !!!
- * Only use FF insert pins
- * Never alter the insert pins to fitt other brand plugs

NEVER USE THE ISTT-125 ON A 1" SHAFT !

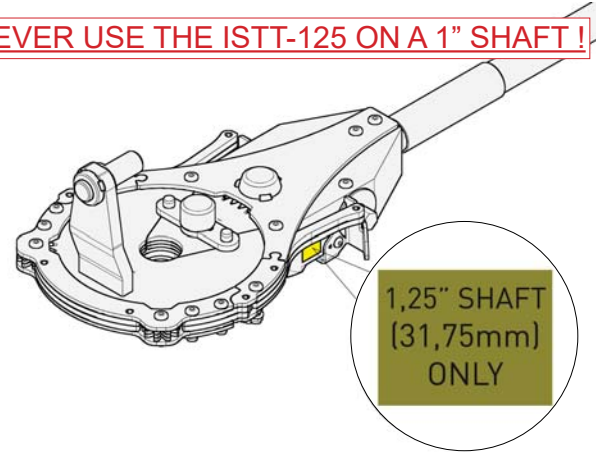

**Check before using the tool !
Do not use the tool when the wear limit is crossed**

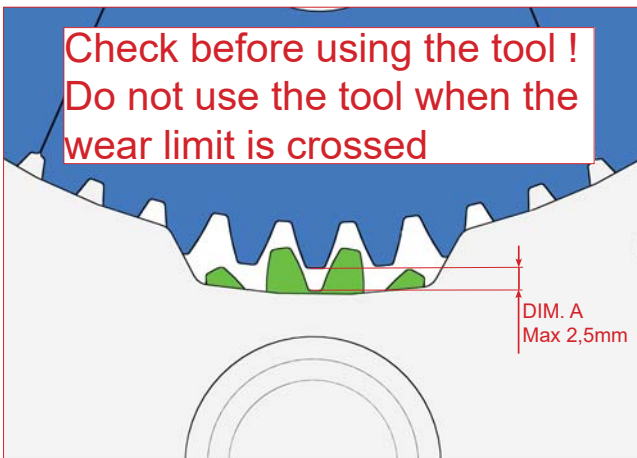

**Check before using the tool !
Do not use the tool when the wear limit is crossed**

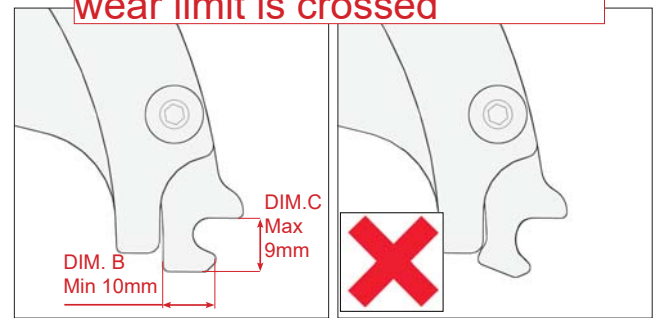

Check before using the tool !

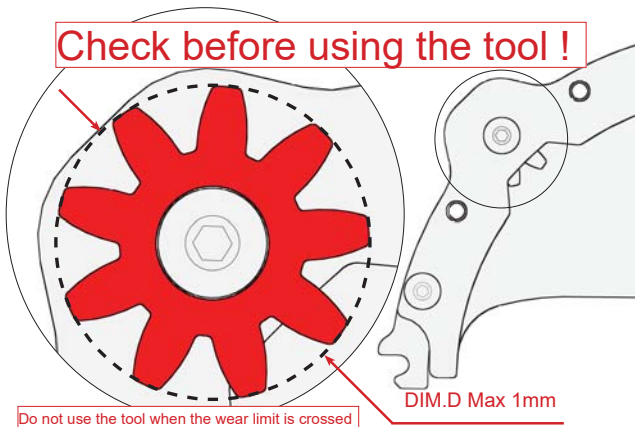

Do not use the tool when the wear limit is crossed

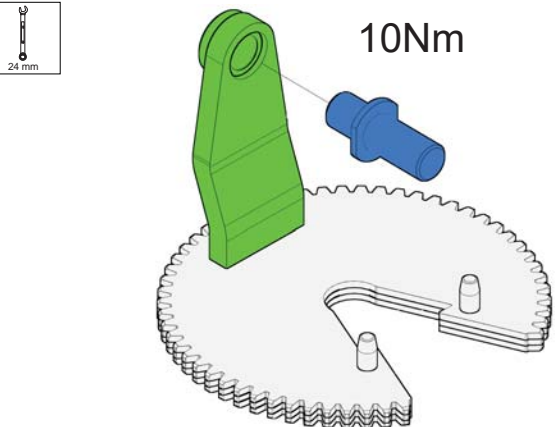

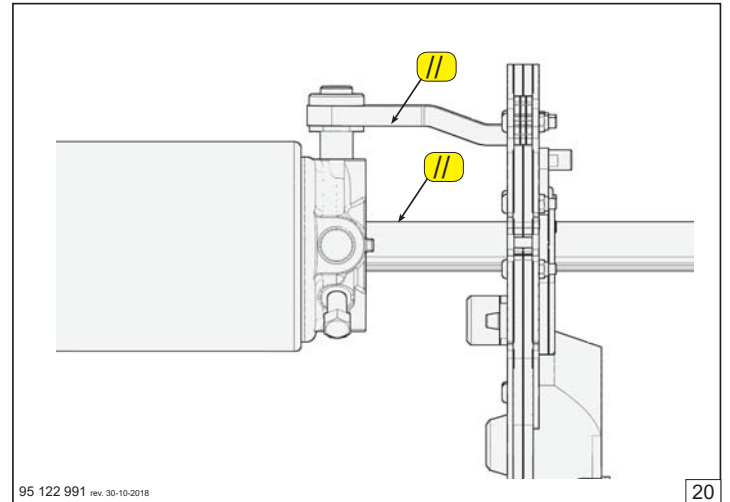
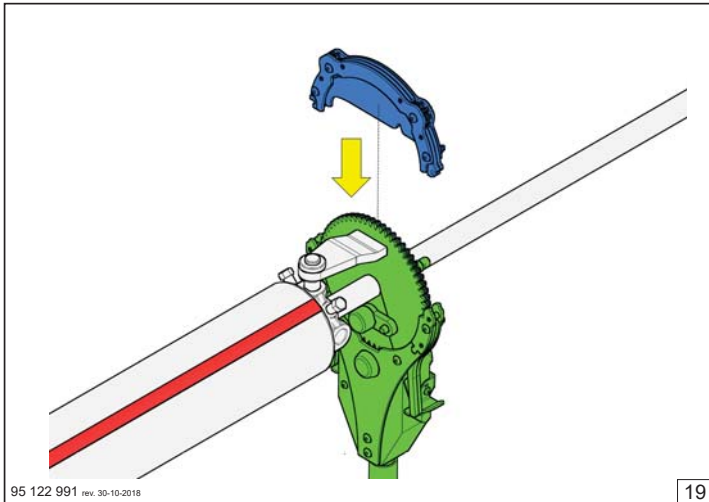
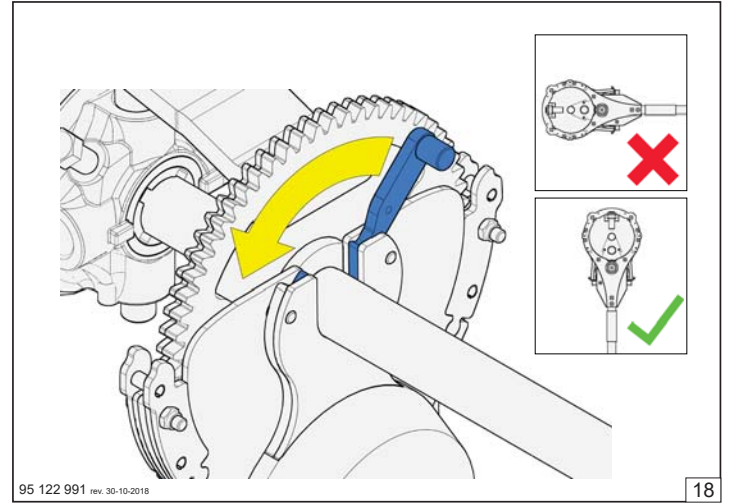
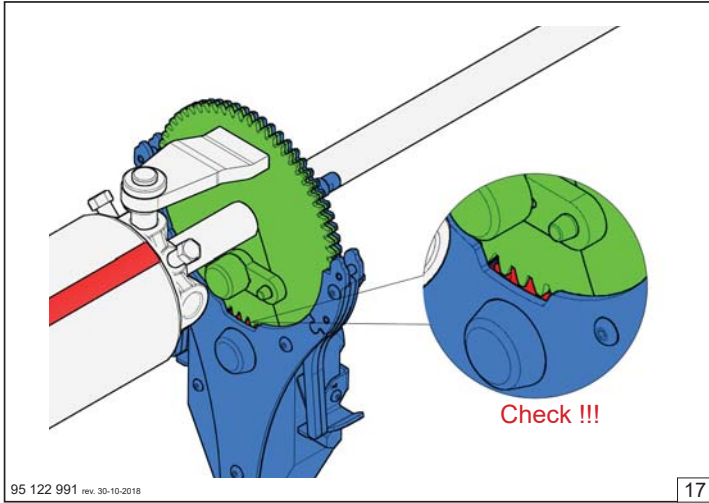
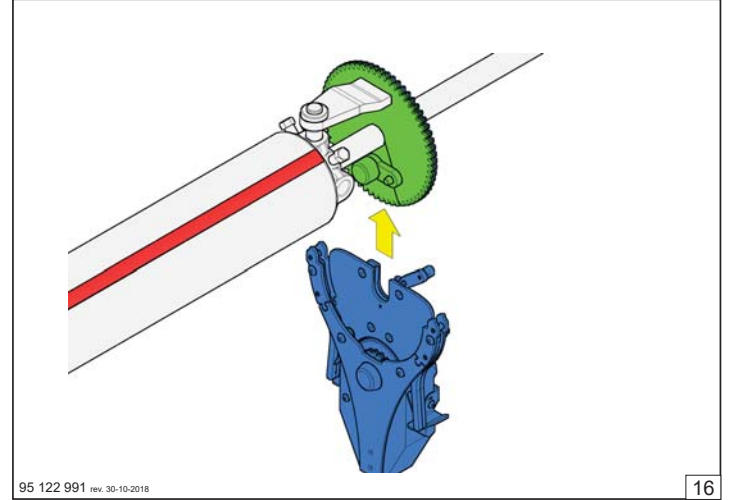
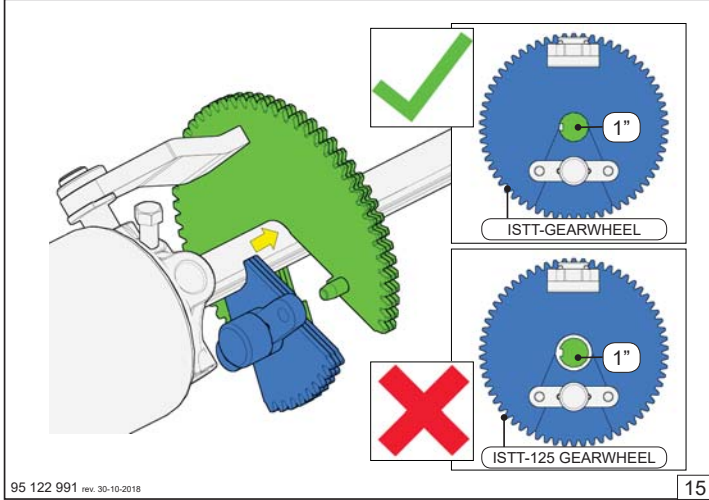
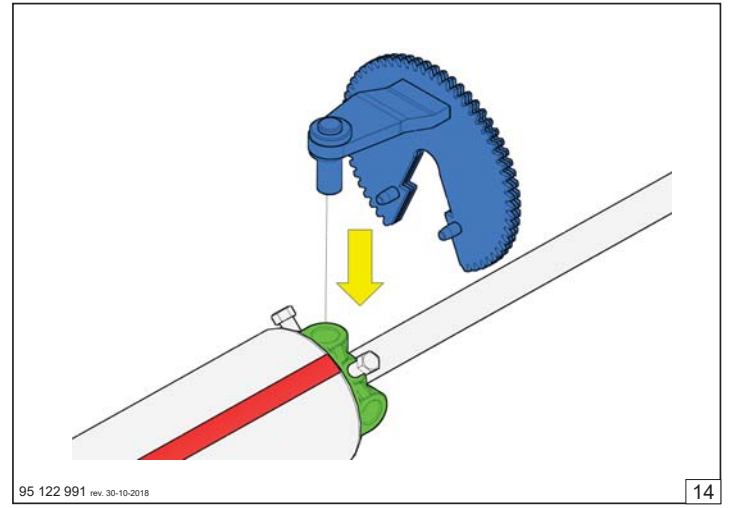
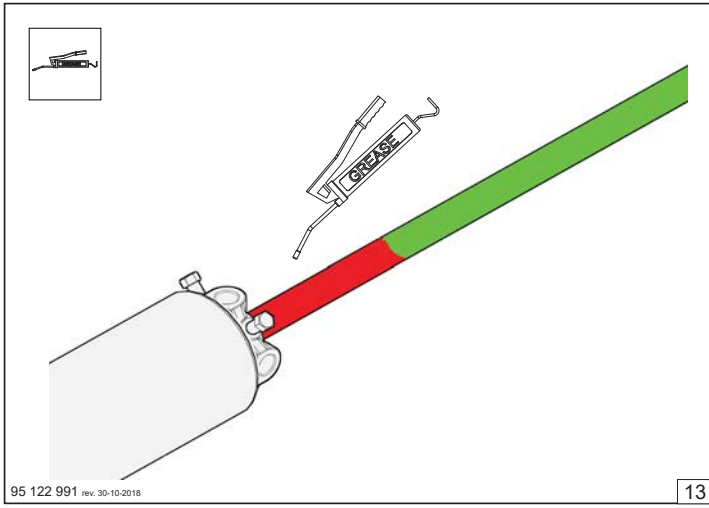

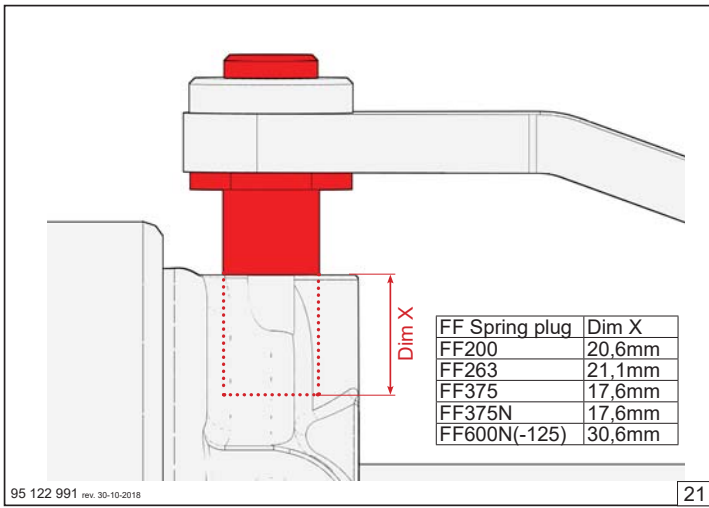

95 122 991 rev. 30-10-2018

21

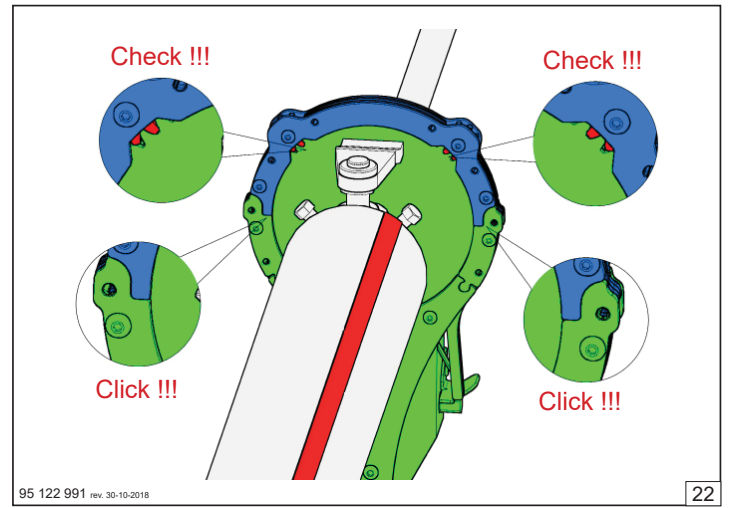

95 122 991 rev. 30-10-2018

22

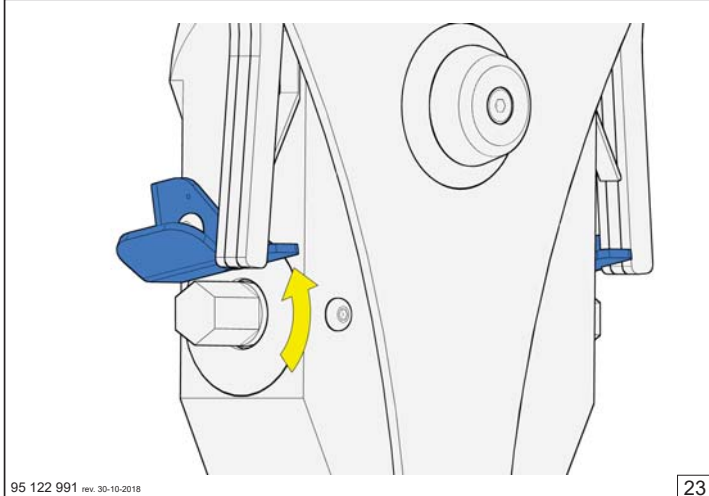

95 122 991 rev. 30-10-2018

23

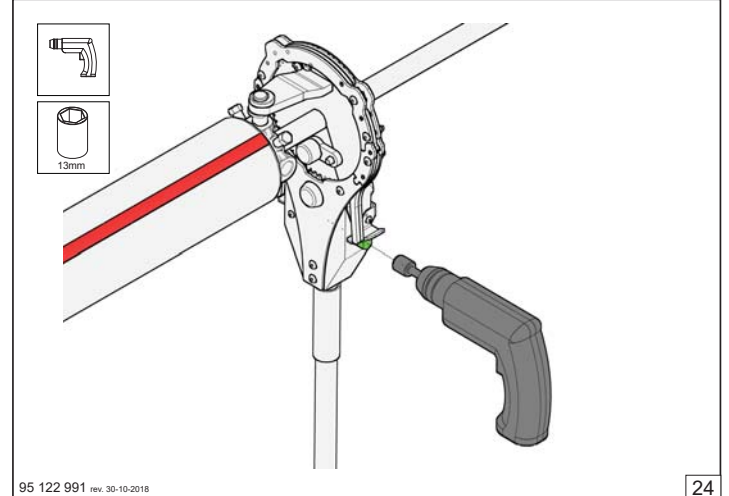

95 122 991 rev. 30-10-2018

24

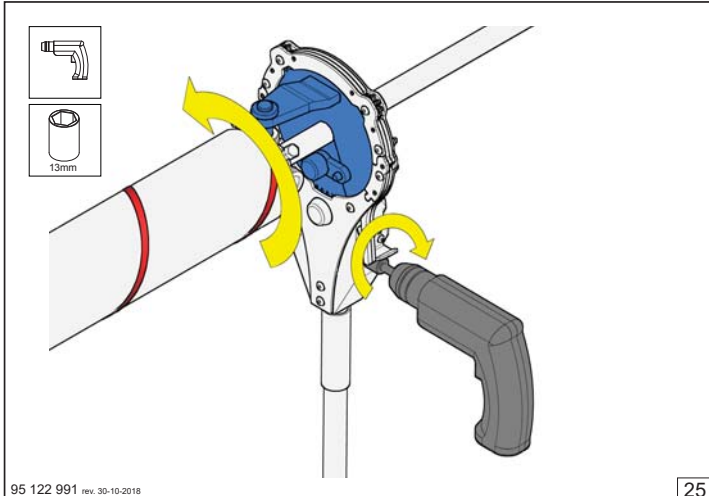

95 122 991 rev. 30-10-2018

25

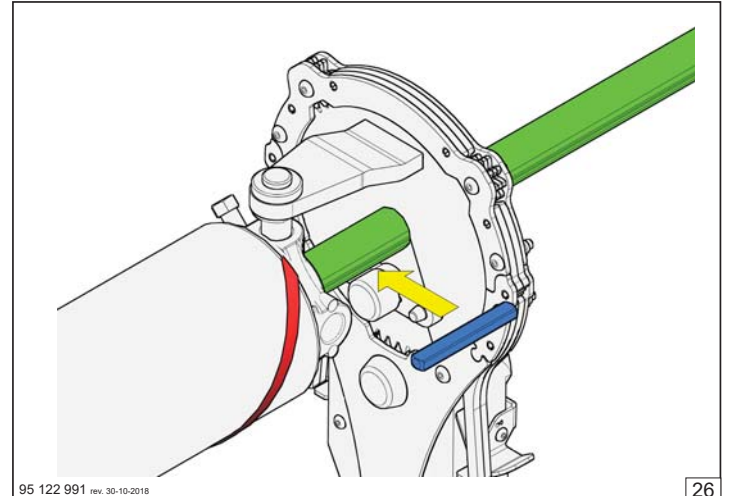

95 122 991 rev. 30-10-2018

26

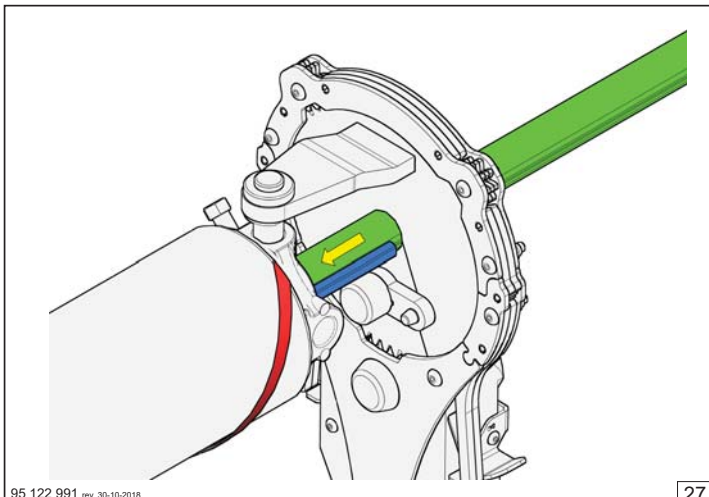

95 122 991 rev. 30-10-2018

27

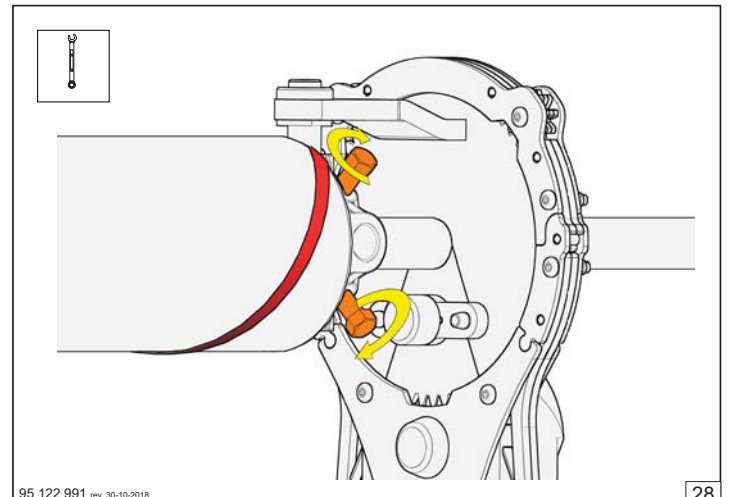

95 122 991 rev. 30-10-2018

28

Release tension

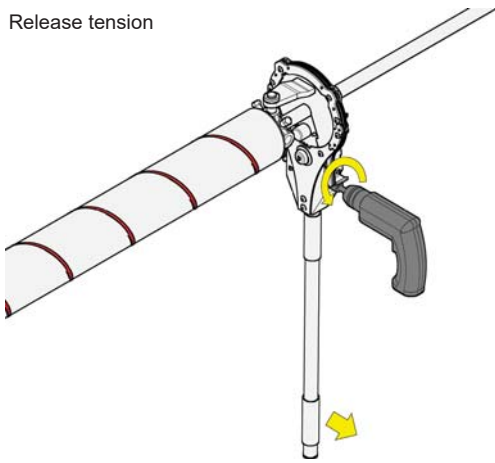

95 122 991 rev. 30-10-2018

29

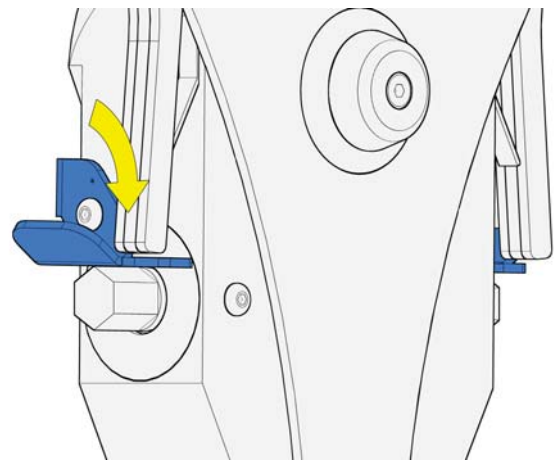

95 122 991 rev. 30-10-2018

30

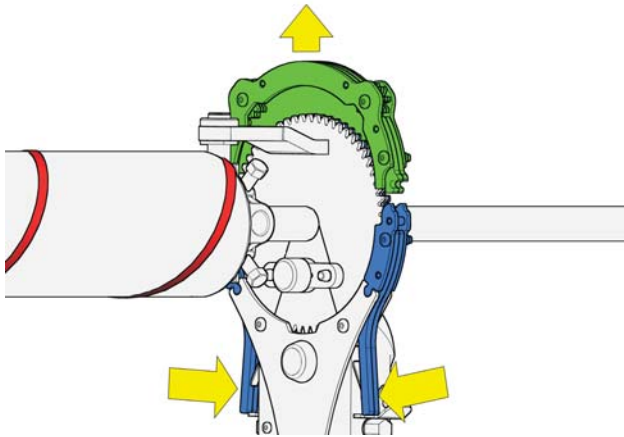

95 122 991 rev. 30-10-2018

31

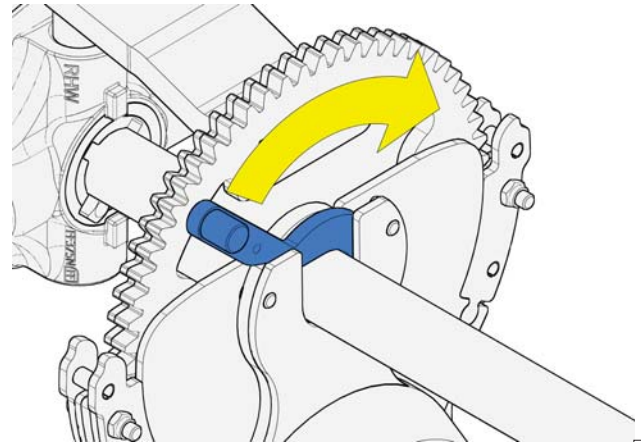

95 122 991 rev. 30-10-2018

32

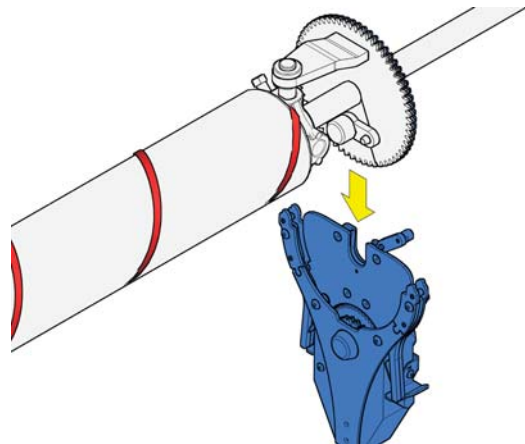

95 122 991 rev. 30-10-2018

33

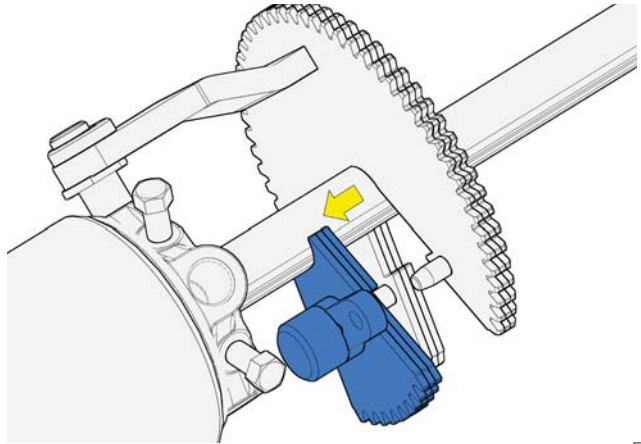

95 122 991 rev. 30-10-2018

34

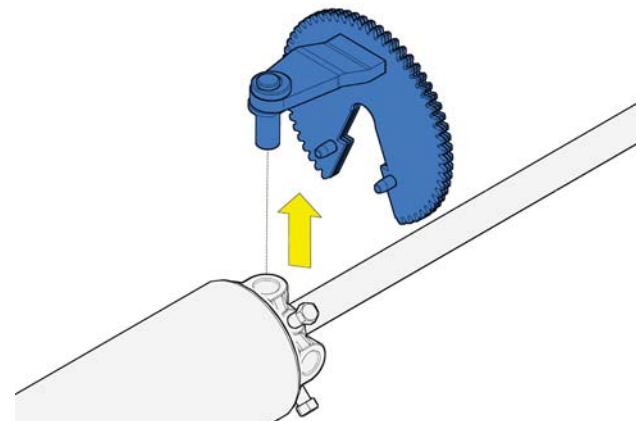

95 122 991 rev. 30-10-2018

35

Use of the ISTT / ISTT-125

⚠ Select the correct version ISTT for used type of shaft

Make sure that one always uses the appropriate insert pen fitting the corresponding plug! (page 7)

During tensioning the driveshaft of the device will get warm, this is normal, the aluminium-casing will absorb the heat.

95 122 991 rev. 30-10-2018

36